

# INSTRUCTION

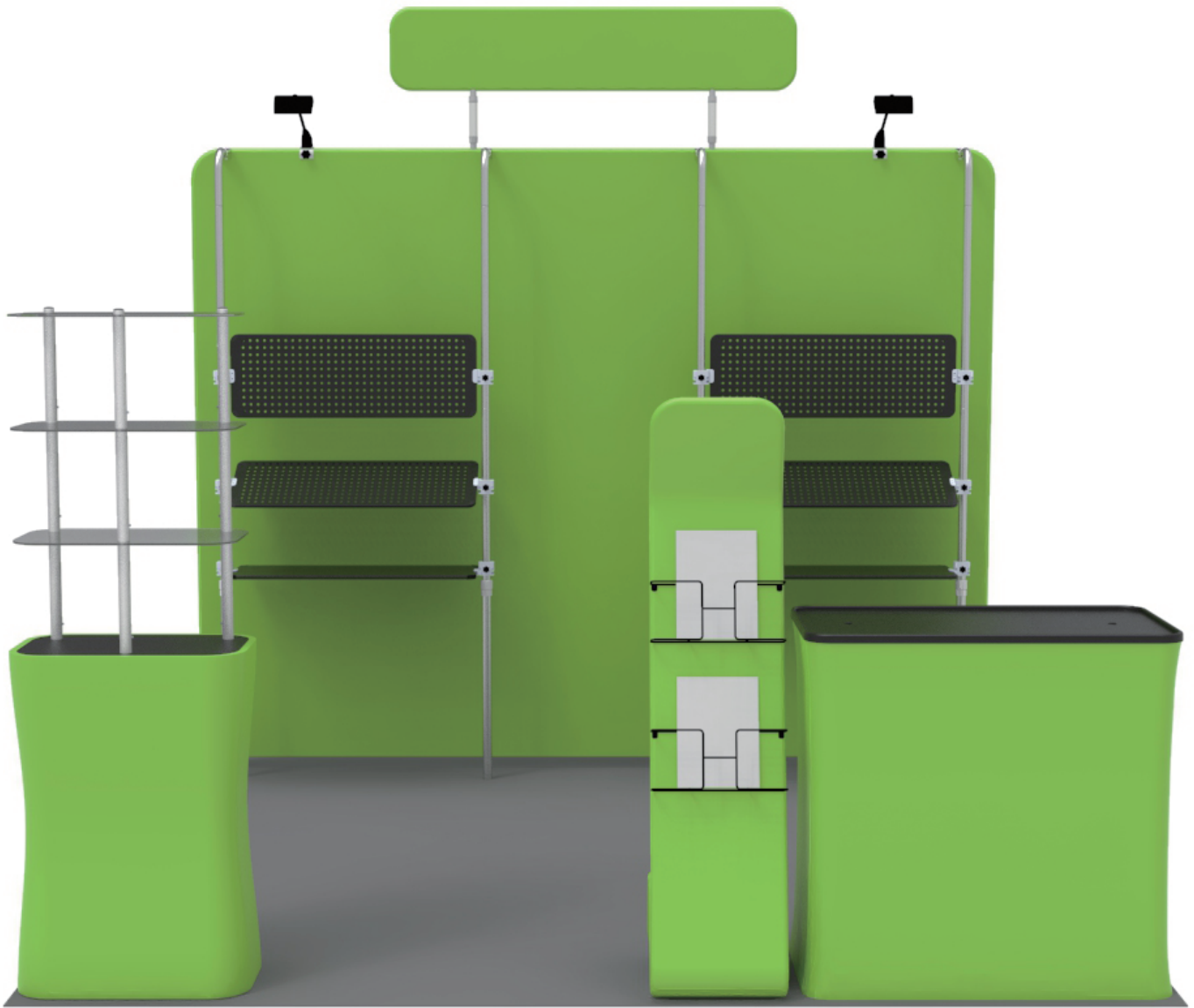

**10X10FT-BOOTH-E**

## STEPS

(1) Hardware

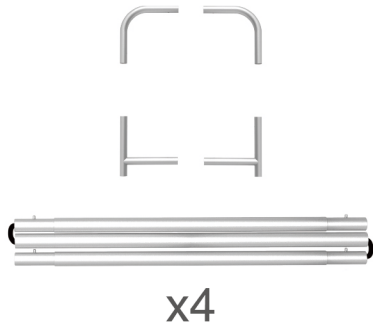

(2) Printed Graphic Fabric Banner (Optional)



### STEP 01

Connect to make long poles according to labelings.

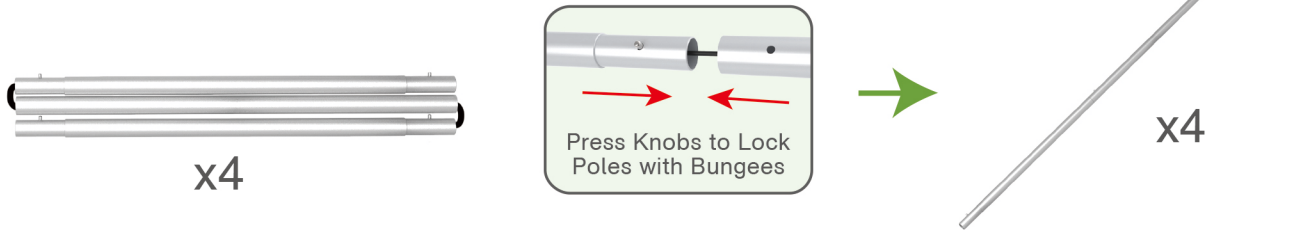

### STEP 02

Connect long poles with corner poles according to labelings.

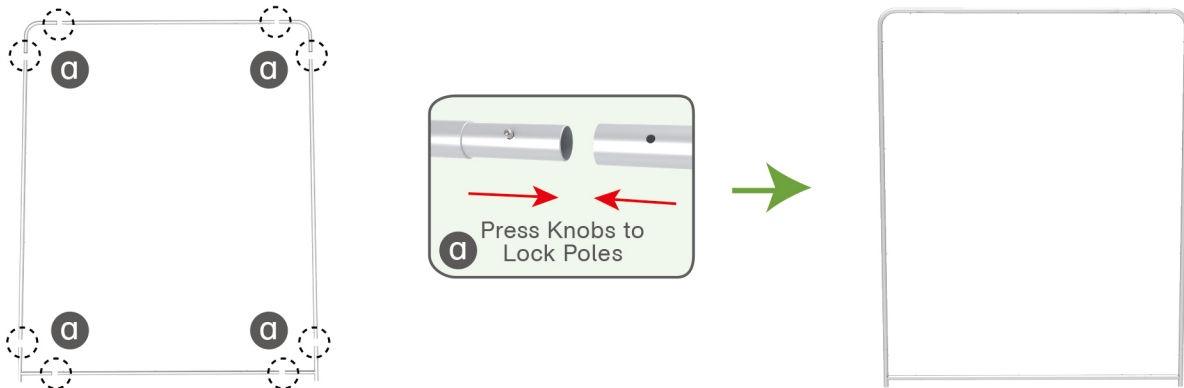

### STEP 03

Slide fabric banner on frame from top and zip up at bottom.

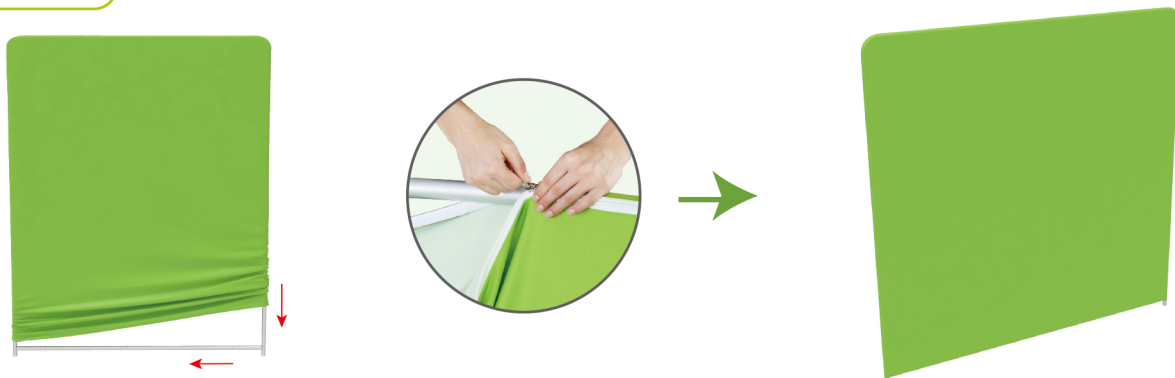

## STEPS

(1) Hardware



(2) Printed Graphic Fabric Banner (Optional)



### STEP 01

Connect poles according to labelings.

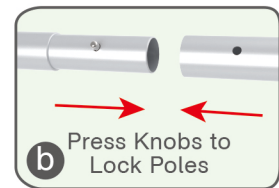
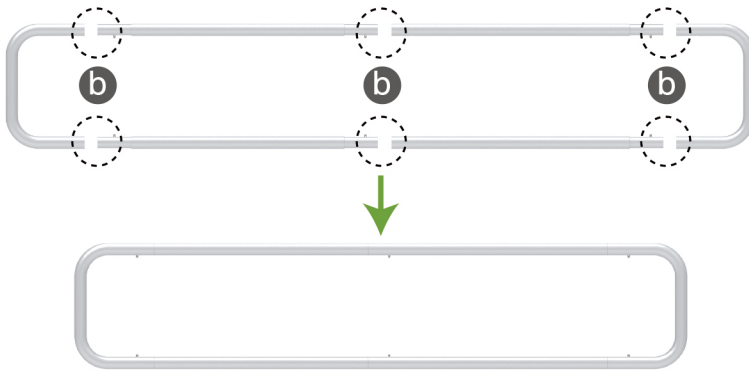

### STEP 02

Slide fabric banner on frame from left and zip up at right.

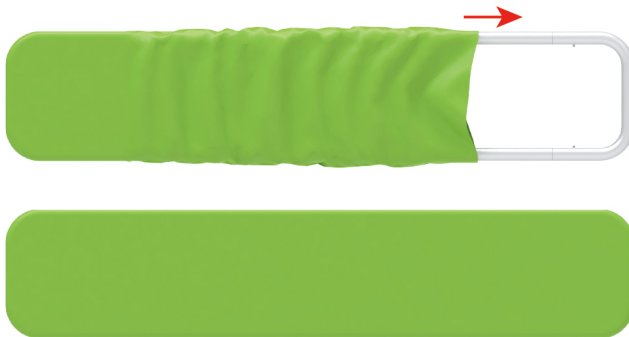

## Booth Set Assembly



(1) Base



(2) Shelving Board

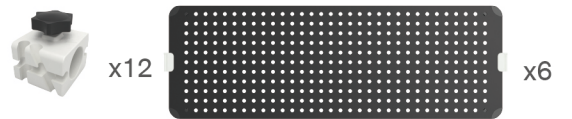

(3) Support Pole

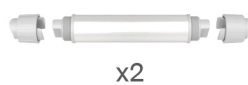

(4) LED Light & Clip



## STEPS

### STEP 01

Insert display stands onto feet by pressing their knobs, connect canopy and display stand with support poles.

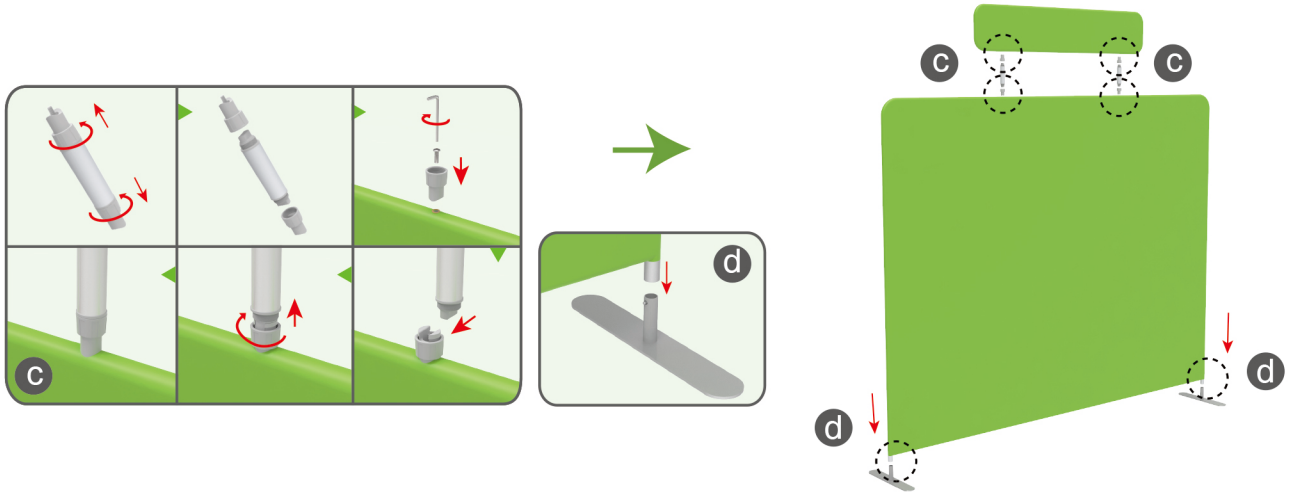

### STEP 02

Connect to make long poles according to labelings, slide three-way clips onto long poles, insert short curved poles onto their top by pressing their knobs.

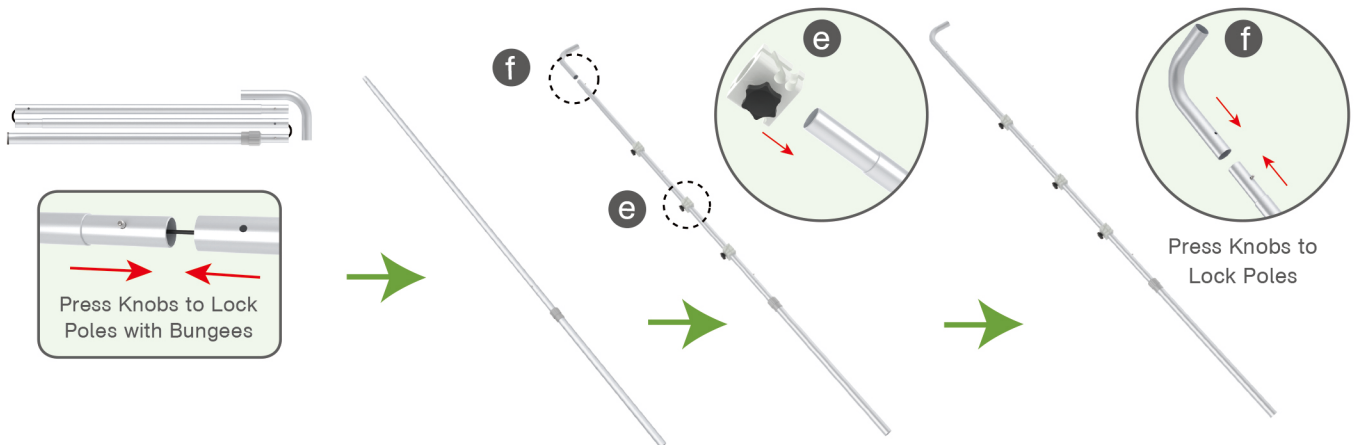

### STEP 03

Connect long poles and display stand with clamps, adjust their height properly as needed by loosening and tightening screws.

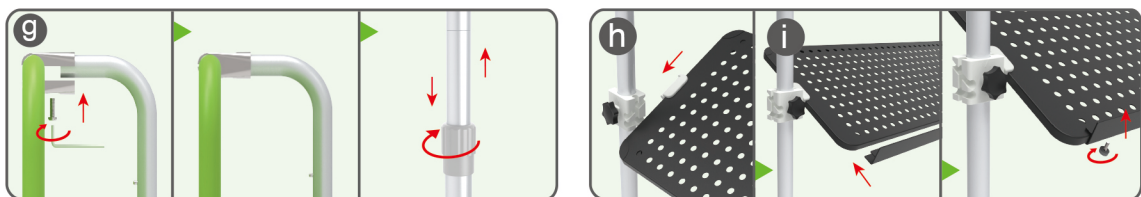

Clip into hanging boards based on directions of three-way clips & tightening with thumb screws, clip F-shaped bar onto hanging board with thumb screws.

## STEPS

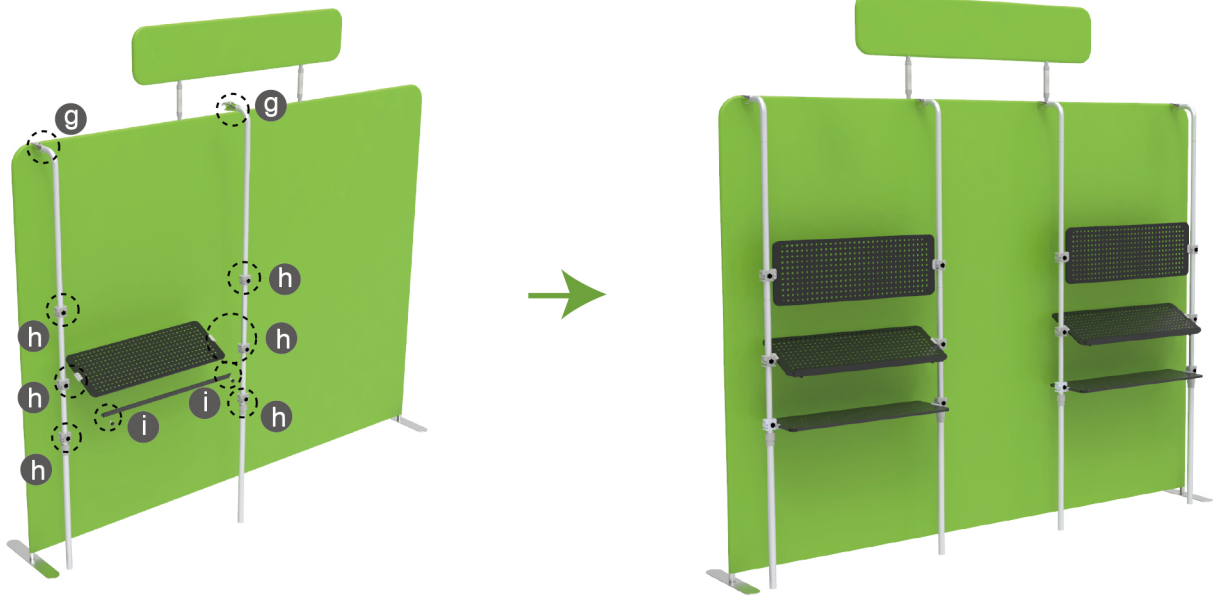

### STEP 04

Screw light clips at top of display stands, slide lights onto them and adjust their direction.

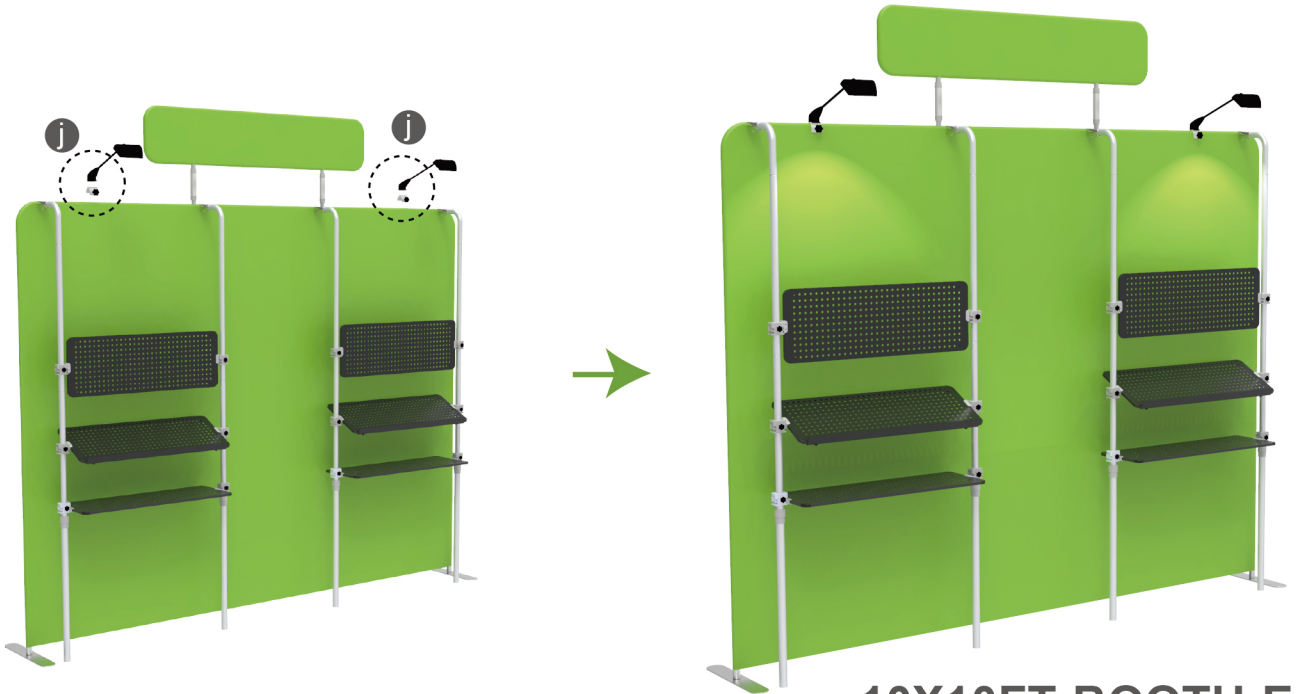
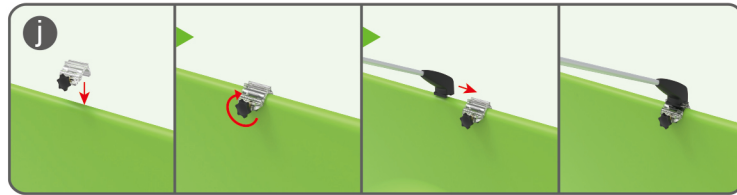

10X10FT-BOOTH-E

## STEPS

(1) Durable Plastic Hard Case, Aluminum Support Poles



(2) Printed Graphic Fabric Banner



### STEP 01

Put hard case's top into fabric banner.

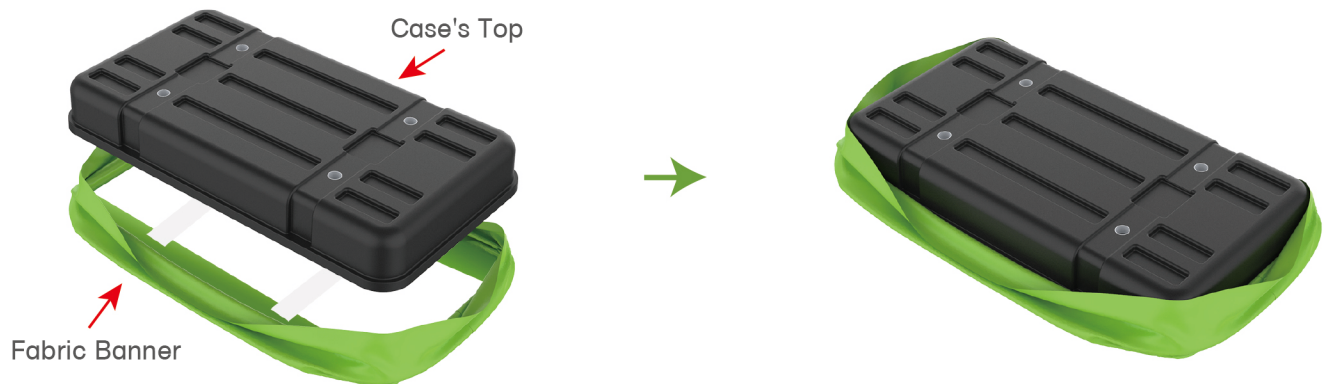

### STEP 02

Insert support poles into hard case's top & bottom.

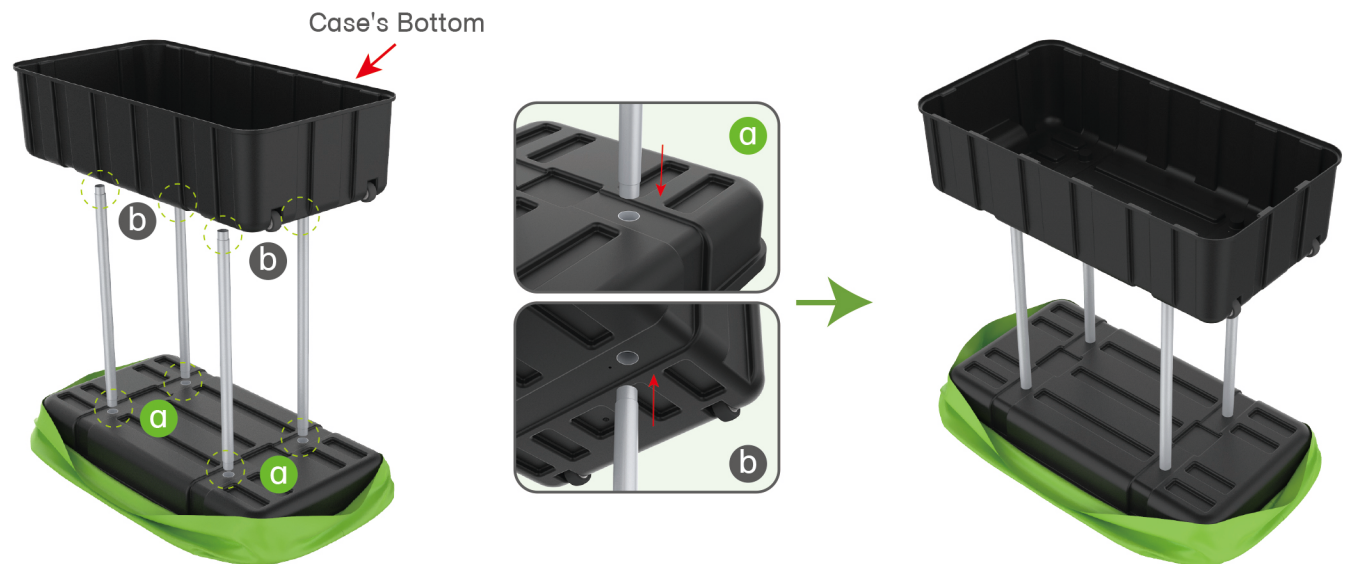

### STEPS

#### STEP 04

Wrap fabric banner from bottom to top & twist it to be smooth, lay hard case's intermediate panel on podium's top.

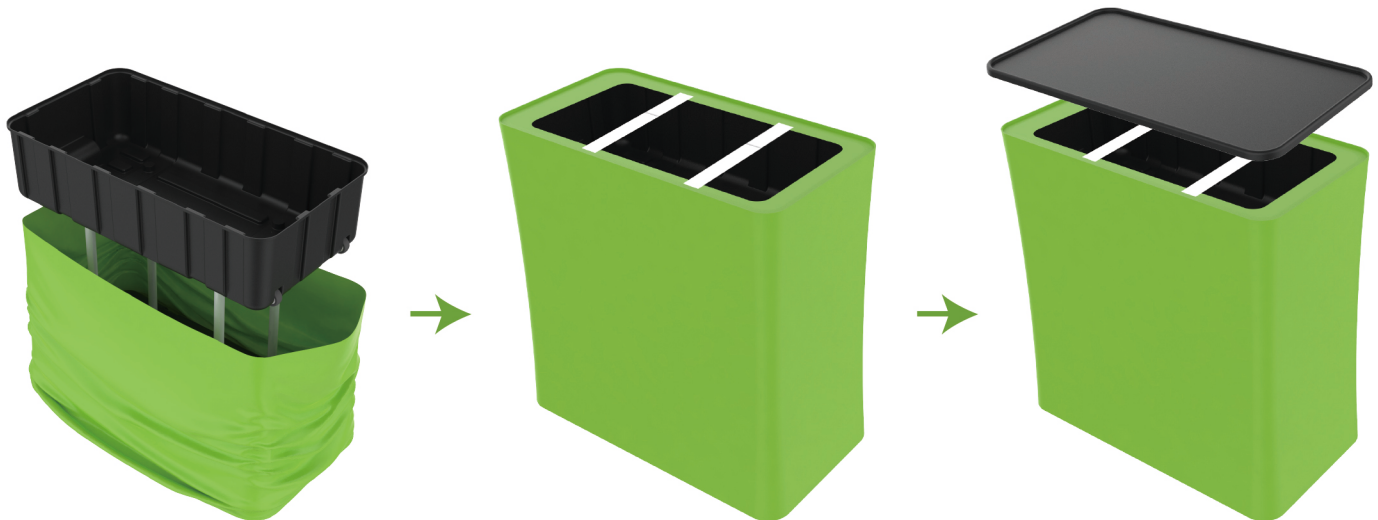

## STEPS

(1) Snap Tubes

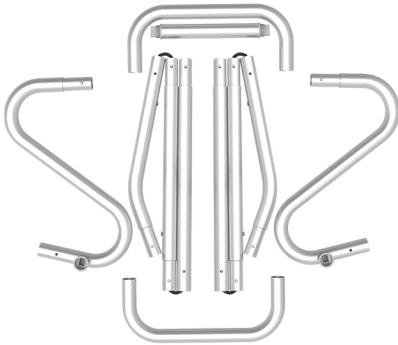

(2) Printed fabric banner



(3) Brochure rack x 2  
Screws x 4

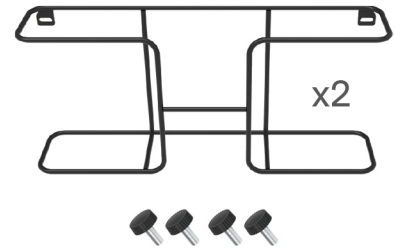

### STEP 01

To Connect the tubes according to the labellings

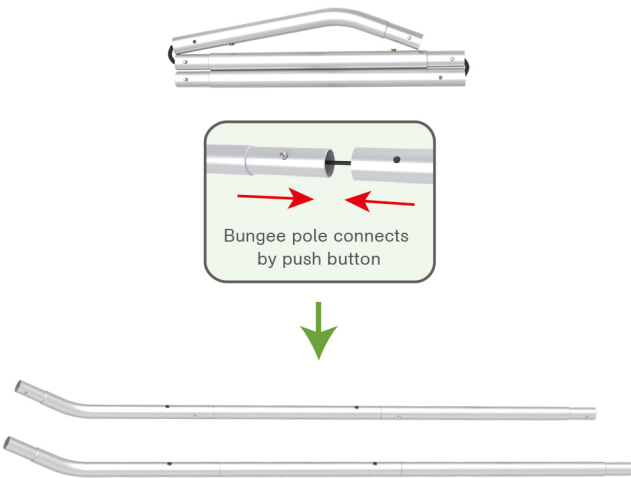

### STEP 02

To connect 2 long side tubes by the corner pieces

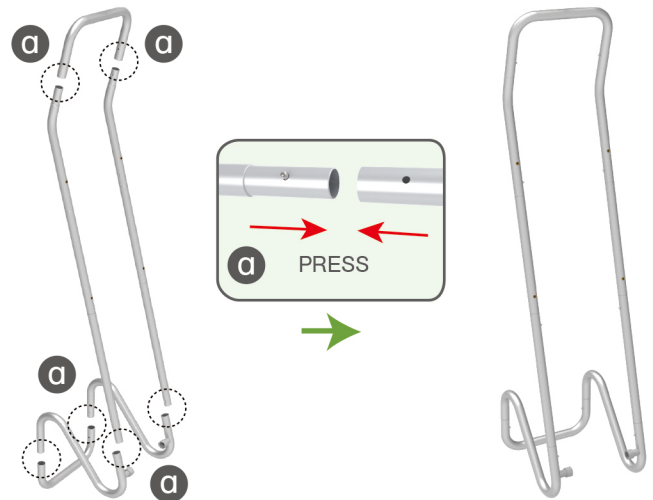

### STEP 03

To install the cross bar according to labellings

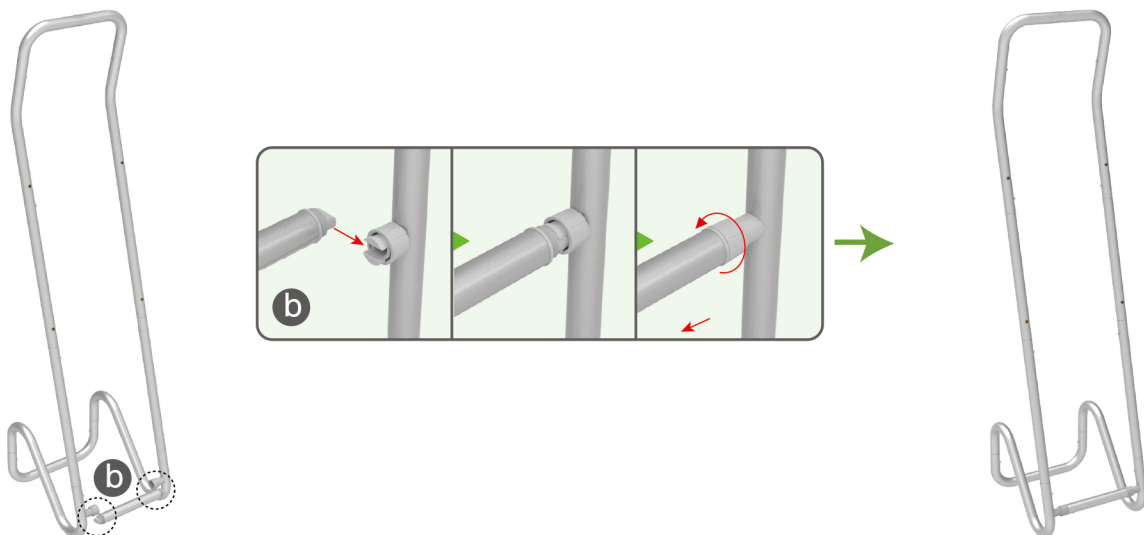



## STEPS

### STEP 04

To Wrap up the fabric banner from top to bottom and zip up.

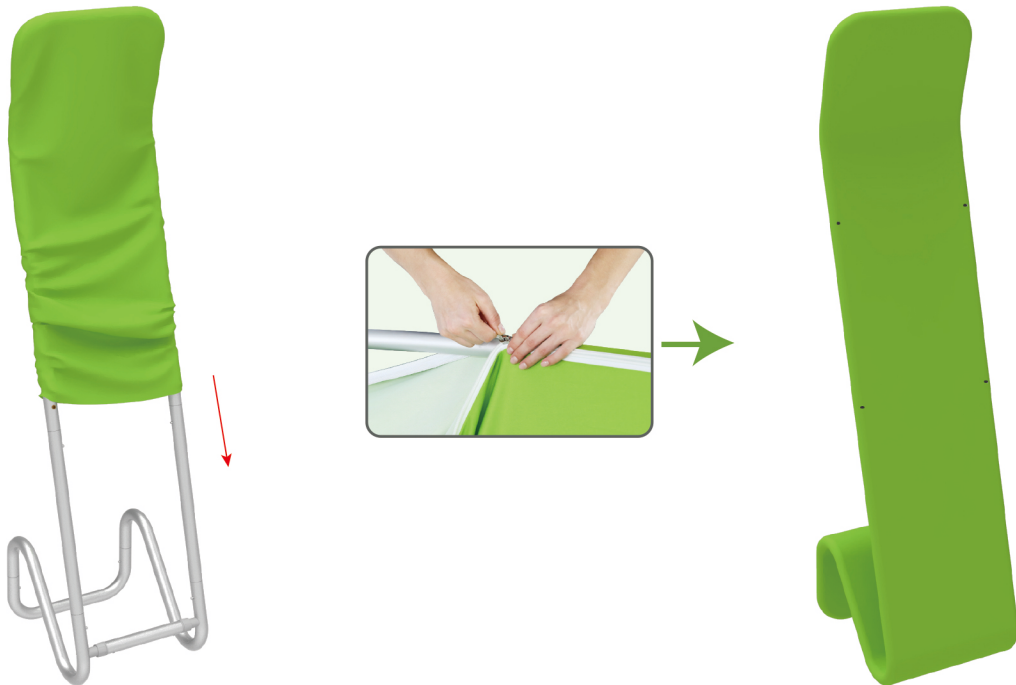

### STEP 05

To install 2 racks by screws in position

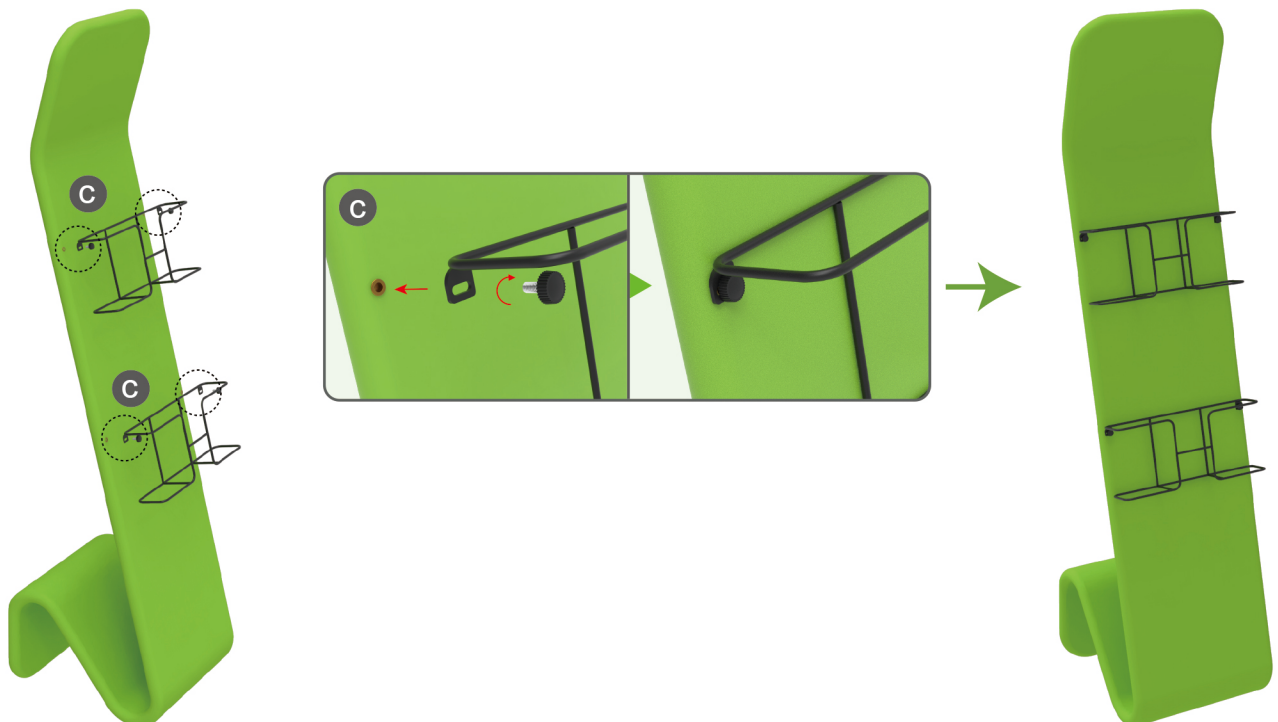

★ One Tool (Hex Wrench) 

### STEPS

#### (1) Straight Support Poles



#### (2) Top MDF Board, Bottom MDF Board, Acrylic Boards

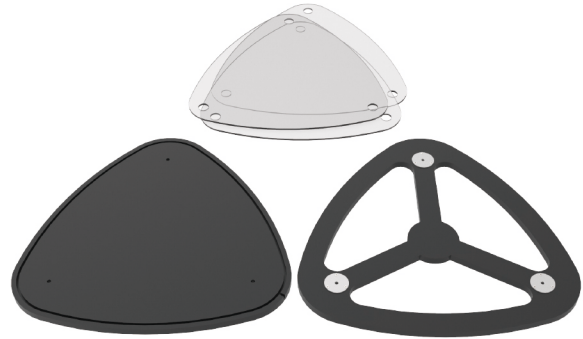

#### (3) Printed Graphic Fabric Banner



#### STEP 01

Connect straight support poles by pressing knobs to lock.

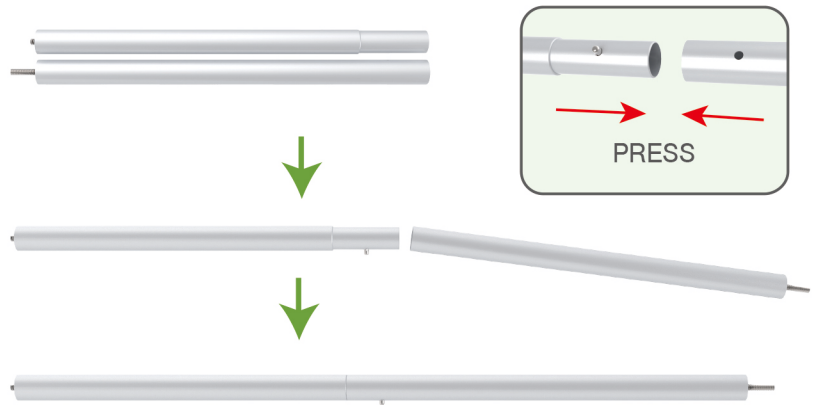

#### STEP 02

Insert fabric banner into bottom MDF board's slot and turn it over.

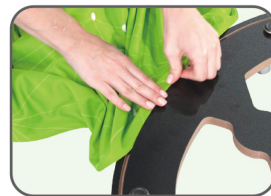

PRESS



### STEPS

#### STEP 03

Screw straight support poles in bottom MDF board's threaded holes and place top MDF board on them.

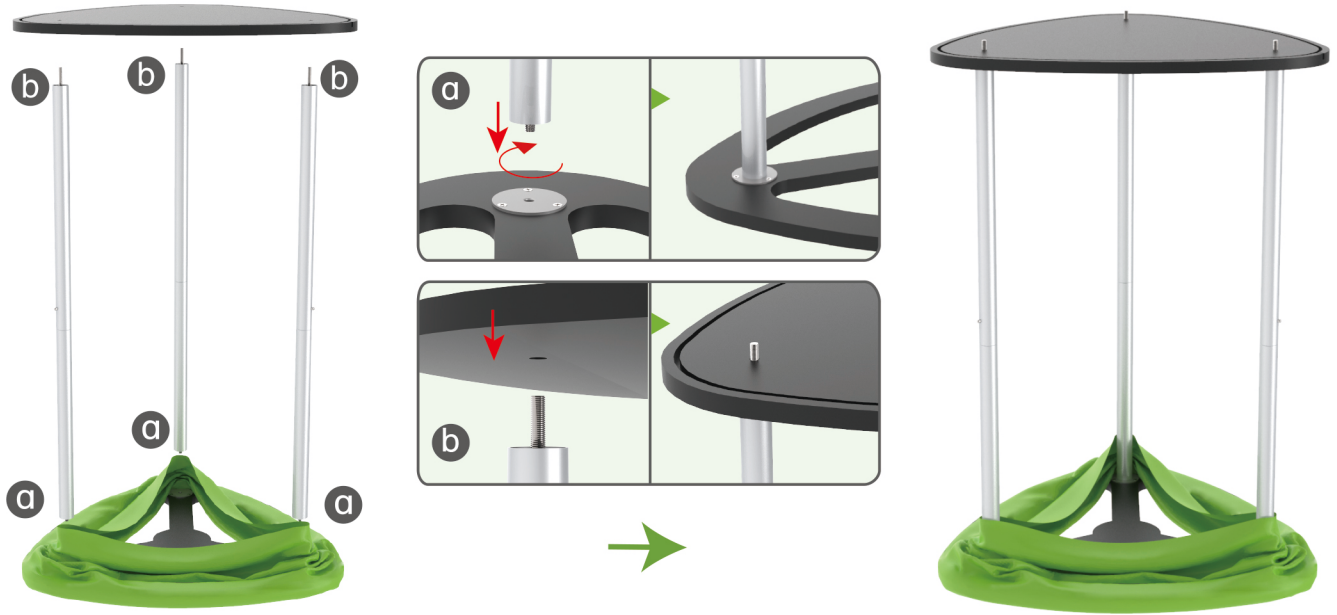

#### STEP 04

Pull fabric banner from bottom to top and insert into top MDF board's slot.



### STEPS

#### STEP 05

Screw straight support poles with threaded holes filled onto nuts and place acrylic boards on them layer by layer.

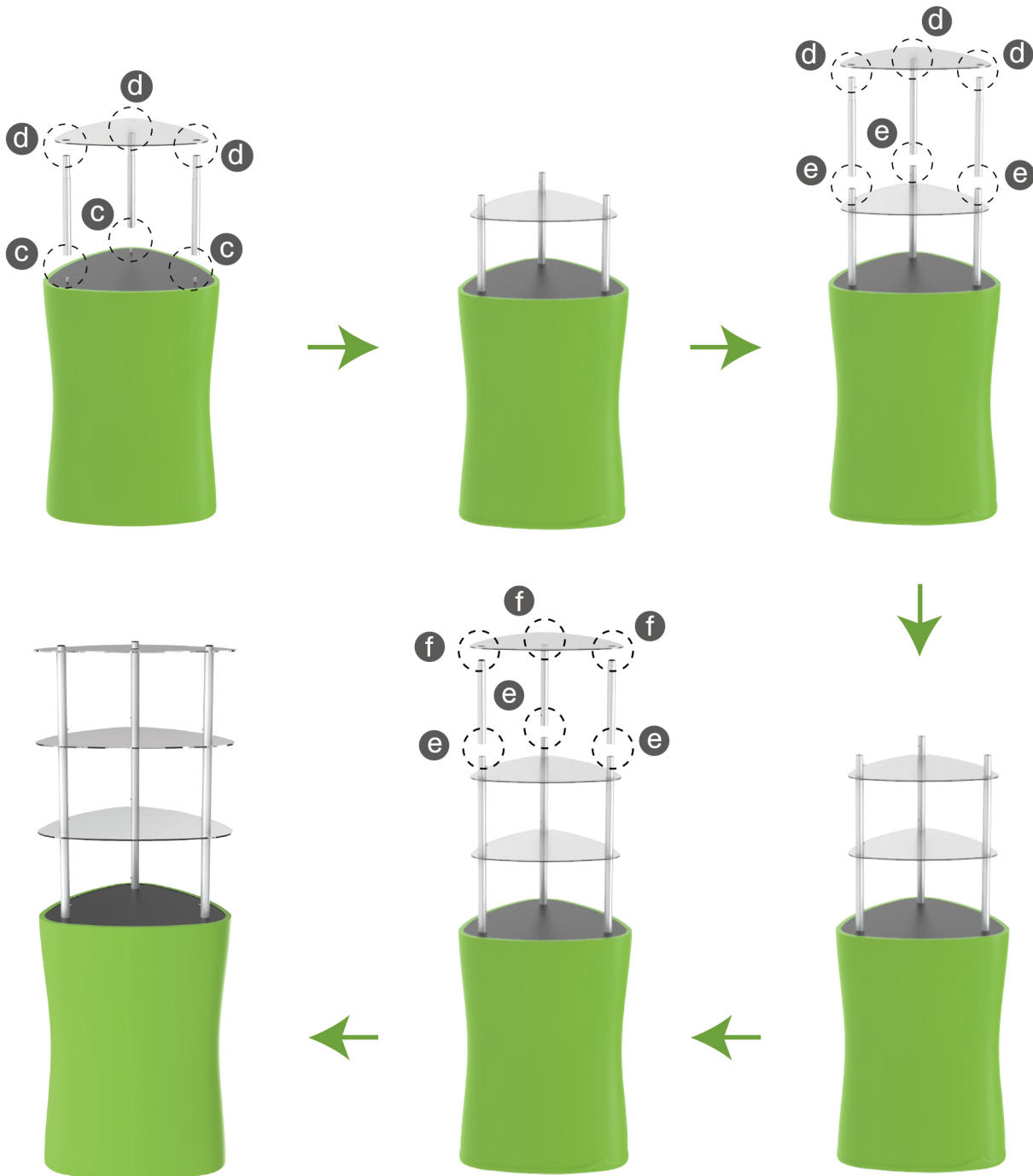
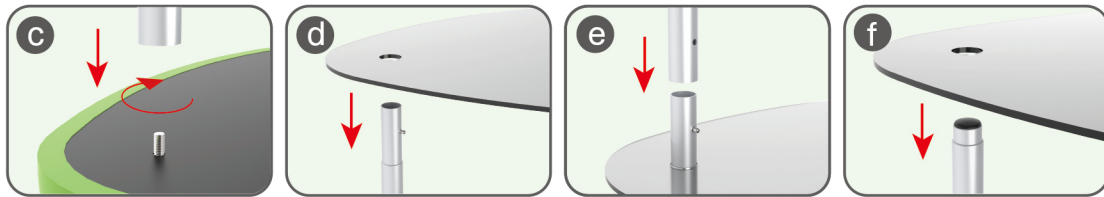

**STEPS**



DT-S-02



DT-S-01



DT-S-03